



 THE BILTMORE  
MIAMI-CORAL GABLES - EST. 1926

 THE BILTMORE  
MIAMI-CORAL GABLES - EST. 1926

1200 Anastasia Avenue Coral Gables, FL 33134  
www.biltmorehotel.com | 305-913-3100  
1-877-576-0793  
@thebiltmoremiami @biltmorehotel

L.V. X.<sup>SM</sup>

*Preferred*  
HOTELS & RESORTS





## LOCATION

The Biltmore, a National Historic Landmark, is located in the exclusive neighborhood of Coral Gables, in the heart of Miami. Surrounded by 150 acres of tropical landscape, the resort is situated in close proximity to Miami International Airport, Miami Beach, Downtown Miami, and many of the city's top attractions.

## GUEST ROOMS

271 individually-styled spacious guest rooms, including 173 suites. All accommodations feature the latest technology services and magnificent skyline panoramic city, pool or golf course views. Welcoming and beautifully appointed with décor chosen with precise focus on Mediterranean and Moorish influences providing a truly superior resort experience.

Two stately-appointed Presidential Suites, one featuring a two-story exclusive accommodation decorated with soaring hand-painted ceilings and the other, a three-primary bedroom penthouse, both of which are located in the Biltmore tower and include views reaching to Biscayne Bay.



## DINING EXPERIENCES

As one of Miami's most diverse dining destinations, The Biltmore Hotel's restaurant portfolio offers a variety of distinctive restaurants, bars and an afternoon tea experience. Whether you seek a beautiful restaurant with an al fresco dining experience, either formal or casual, the Biltmore has myriad award-winning options to choose from. All feature the world-class cuisine and service that have created an internationally renowned culinary legacy for the hotel.

### FONTANA

Open for breakfast, lunch and dinner, Fontana offers Italian-inspired cuisine that can be enjoyed indoors or outdoors at a lushly landscaped courtyard which features a soothing fountain for which the restaurant was named.

### CASCADE

Cascade offers al-fresco poolside dining that features a lighter fare of lunch specialties, afternoon tapas, cold beverages and cocktails.

### FAIRWAYS

A classic golf club restaurant and bar, featuring terrace seating with direct views of the golf course. Indoor seating also available.

### CELLAR BAR

An intimate space, adjacent to Fontana that specializes in craft cocktails. Lite bites are also available.

### BILTMORE BAR

This handsome wood paneled lounge offers a sophisticated atmosphere for cocktails and conversation. Live music every Friday and Saturday evening.

### POSTO DOLCE

All manner of delectable offerings awaits your enjoyment at our "sweet place" including gourmet coffees, gelato, elegant desserts, wraps and grab & go meals.

### AFTERNOON TEA

A tradition steeped in history enjoyed in the hotel's majestic lobby. The ambiance is set with the gentle and drifting melodies of a noted harpist and tablescapes elegantly designed in the palette of soft garden flowers and butterflies.

### SIGNATURE SUNDAY BRUNCH

Enjoy a plethora of stations including from traditional breakfast and carving favorites to stations dedicated to caviar, seafood, sushi and dessert. And of course, bottomless bubbly.



## LIFESTYLE AND RECREATION

Immerse yourself in luxury and our endless amenities.

### SPA

The elegant Biltmore Spa is a 12,000-square-foot sanctuary for personal peace and tranquility, offering full salon services in addition to the most contemporary treatments and therapies.

### GOLF

The Biltmore Golf Course is an 18-hole, par-71 championship course, originally designed by noted golf course architect Donald Ross.

### FITNESS

The Fitness Center features an extensive collection of Technogym machines and weekly exercise classes including Aqua Fitness, Boot Camps, Pilates, Group Cycle, Yoga, and Zumba.

### TENNIS

The Kerdyk Biltmore Tennis Center is one of the premier tennis destinations in Florida offering 9 courts of play.

### POOL & CABANAS

The iconic pool at The Biltmore is one of the largest hotel pools in the United States and features 9 beautifully appointed private cabanas.

### JIM MCLEAN GOLF SCHOOL

The Jim McLean Golf School at The Biltmore Hotel offers a comprehensive variety of lessons and golf instruction experiences with world class golf professionals and state-of-the-art techniques.

## MEETING & EVENT SPACE

The Biltmore Hotel remains Miami's premier Meeting & Convention Venue featuring over 75,000 sq. ft. of indoor/outdoor meeting and function space housed within two locations on the Biltmore grounds - within the hotel itself and at the adjacent Conference Center of the Americas. The Biltmore offers exceptional space with natural daylight, no air walls, three ballrooms, surrounded by grandeur terraces, breakout rooms, two state-of-the-art amphitheatres and executive boardrooms. Our poolside private cabanas can be used for breakouts.

In 1994, the first Summit of the Americas was held at The Biltmore. 34 heads of state from the western hemisphere convened at our world-class conference center.

Biltmore Event Design is available to coordinate corporate team building events, design, décor and entertainment needs for all events. Group privatization available, upon request.



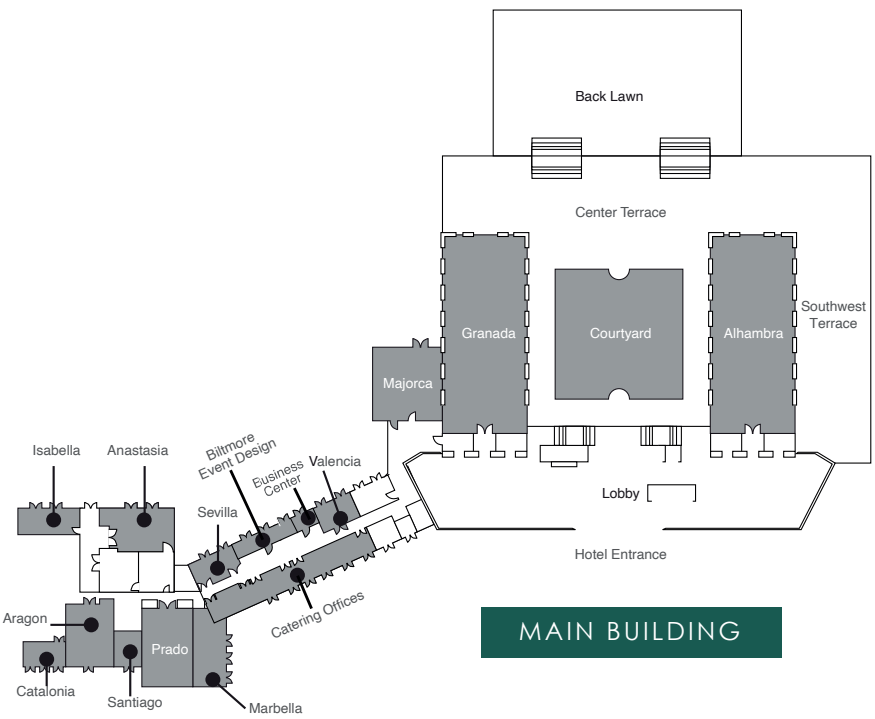

**MAIN BUILDING**

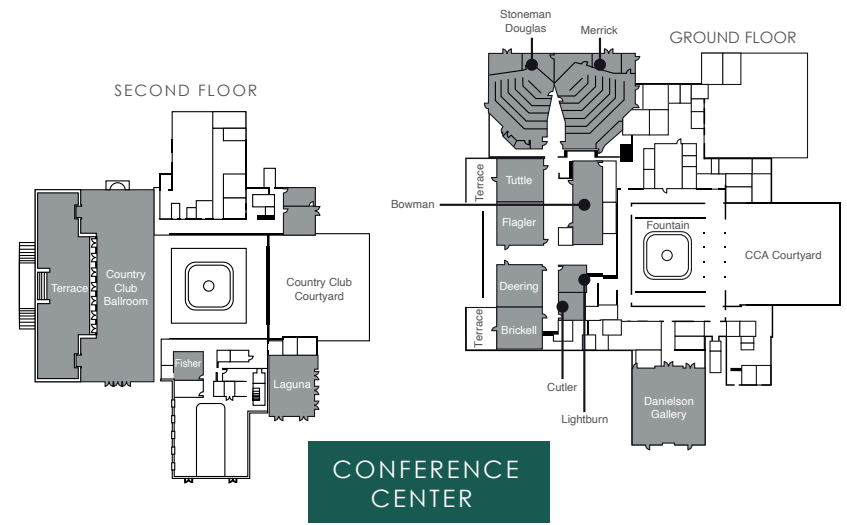

**CONFERENCE CENTER**



	CONF	RECEP	THTR	CLSRM	U-SHP	HLLW SQ	RNDS
<b>ALHAMBRA</b> 96' X 39' X 25'	86	500	400	200	90	100	270
<b>SW TERRACE</b>	--	500	200	--	--	--	350
	6490 SQ.FT   603 SQ METERS						
<b>GRANADA</b> 96' X 39' X 25'	86	500	400	200	90	100	280
	3744 SQ.FT   347 SQ METERS						
<b>CTR TERRACE</b>	--	500	200	--	--	--	350
	5811 SQ.FT   540 SQ METERS						
<b>BACK LAWN</b> 96' X 39' X 25'	--	200	200	--	--	--	160
	2396 SQ.FT   223 SQ METERS						
<b>MAJORCA</b> 35' X 24' X 10'	28	70	70	50	32	40	60
	852 SQ.FT   79 SQ METERS						
<b>MARBELLA</b> 35' X 19' X 8'	28	60	80	40	30	36	60
	701 SQ.FT   65 SQ METERS						
<b>PRADO</b> 48' X 28' X 9'	40	100	120	80	48	58	80
	1373 SQ.FT   128 SQ METERS						
<b>ANASTASIA</b> 34' X 21' X 9'	28	60	70	48	30	40	60
	734 SQ.FT   68 SQ METERS						
<b>ARAGON</b> 40' X 28' X 9'	34	90	100	72	38	44	80
	1134 SQ.FT   105 SQ METERS						
<b>ISABELLA</b> 28' X 12' X 8'	12	--	--	--	--	--	--
	356 SQ.FT   33 SQ METERS						
<b>CATALONIA</b> 23' X 15' X 9'	10	--	--	--	--	--	--
	365 SQ.FT   34 SQ METERS						
<b>VALENCIA</b> 24' X 14' X 11'	8	--	--	--	--	--	--
	334 SQ.FT   31 SQ METERS						
<b>SEVILLA</b> 27' X 12' X 9'	10	--	--	--	--	--	--
	400 SQ.FT   37 SQ METERS						

	CONF	RECEP	THTR	CLSRM	U-SHP	HLLW SQ	RNDS
<b>STONEMAN</b> 47' X 60' X 14'	--	--	--	60	--	--	--
	2496 SQ.FT   232 SQ METERS						
<b>MERRICK</b> 59' X 65' X 14'	--	--	--	90	--	--	--
	3520 SQ.FT   327 SQ METERS						
<b>TUTTLE</b> 31' X 29' X 9'	24	80	70	40	30	38	60
	929 SQ.FT   86 SQ METERS						
<b>TUTTLE TERRACE</b>	--	75	--	--	--	--	60
	880 SQ.FT   82 SQ METERS						
<b>FLAGLER</b> 30' X 31' X 9'	24	40	60	40	25	30	50
	871 SQ.FT   81 SQ METERS						
<b>BOWMAN</b> 61' X 20' X 9'	50	120	120	72	54	60	100
	1271 SQ.FT   118 SQ METERS						
<b>DEERING</b> 30' X 31' X 9'	24	40	60	40	25	30	50
	871 SQ.FT   81 SQ METERS						
<b>LIGHTBURN</b> 20' X 18' X 8'	16	--	32	20	16	20	20
	385 SQ.FT   36 SQ METERS						
<b>CUTLER</b> 20' X 18' X 8'	16	--	32	20	16	20	20
	385 SQ.FT   36 SQ METERS						
<b>BRICKELL</b> 31' X 29' X 9'	24	80	70	40	30	38	60
	934 SQ.FT   87 SQ METERS						
<b>BRICKELL TER.</b>	--	75	--	--	--	--	60
	880 SQ.FT   82 SQ METERS						
<b>DANIELSON</b> 57' X 51' X 19'	44/44	350	200	72/60	50	58	200/120
	2933/1900 SQ.FT		272/176 SQ METERS				
<b>CC BALLROOM</b> 136' X 48' X 46'	124	700	600	275	130	140	500
	6528 SQ.FT   606 SQ METERS						
<b>CC COURTYARD</b>	--	1000	400	--	--	--	650
	10,420 SQ.FT   968 SQ METERS						
<b>CC TERRACE</b>	--	500	350	--	--	--	350
	5560 SQ.FT   517 SQ METERS						
<b>LAGUNA</b> 46' X 32' X 16'	40	100	80	32	--	--	110
	1472 SQ.FT   137 SQ METERS						
<b>FISHER</b> 21' X 18' X 9'	18	--	30	12	--	--	30
	378 SQ.FT   35 SQ METERS						

