



EMBASSY SUITES

by HILTON™

Orlando Lake Buena Vista South

Facilities Guide

ORLANDO
LAKE
BUENA
VISTA
SOUTH

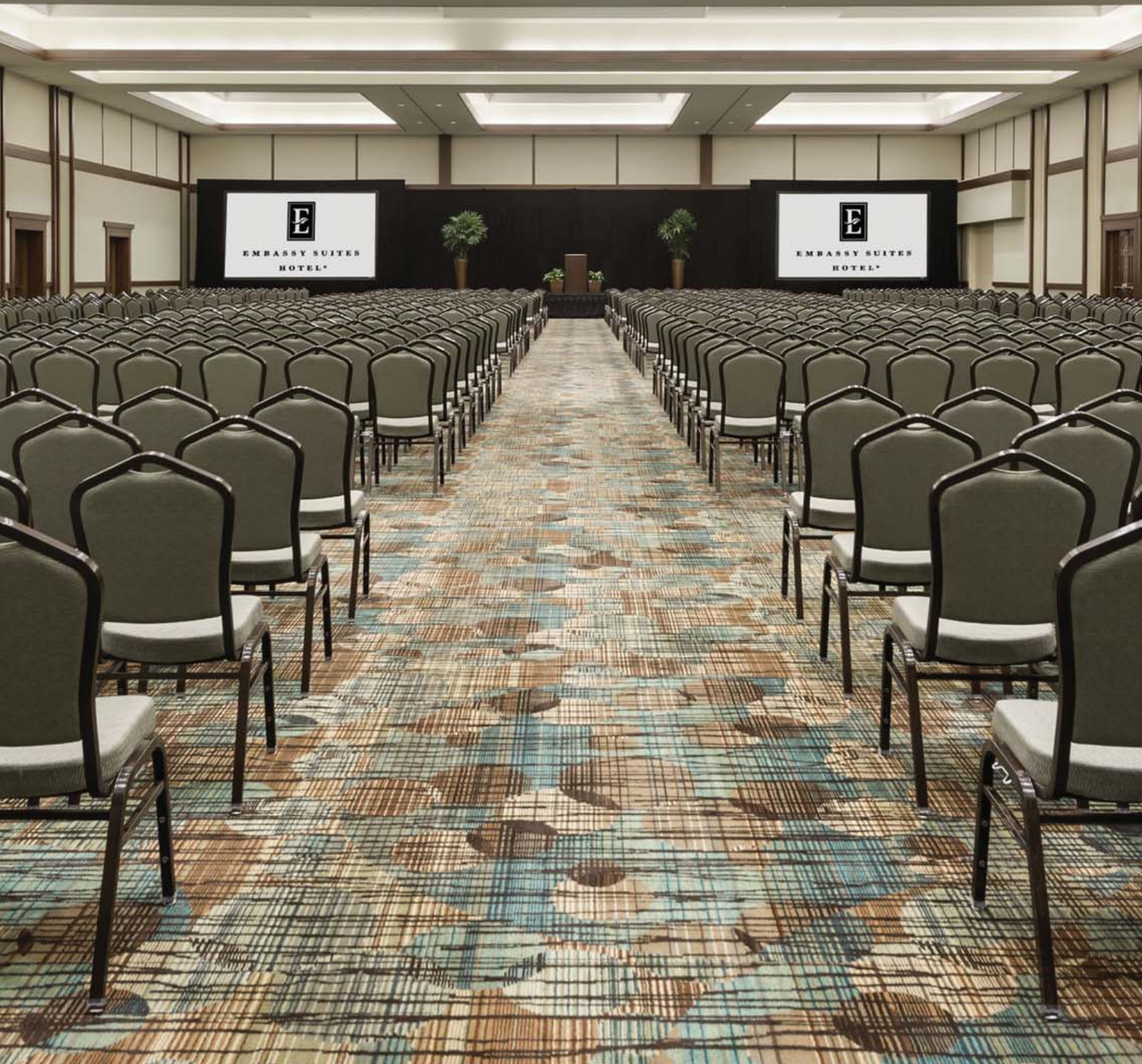

CONVENTION SPACE

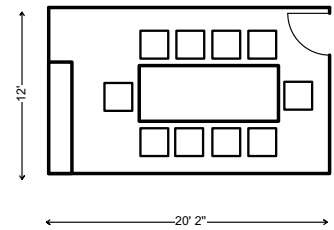
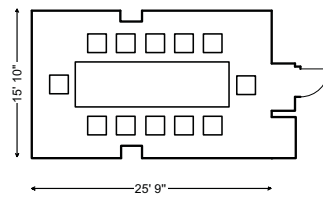
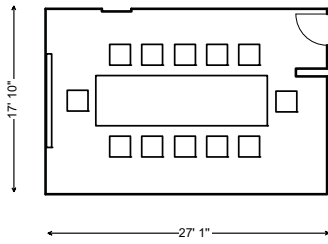
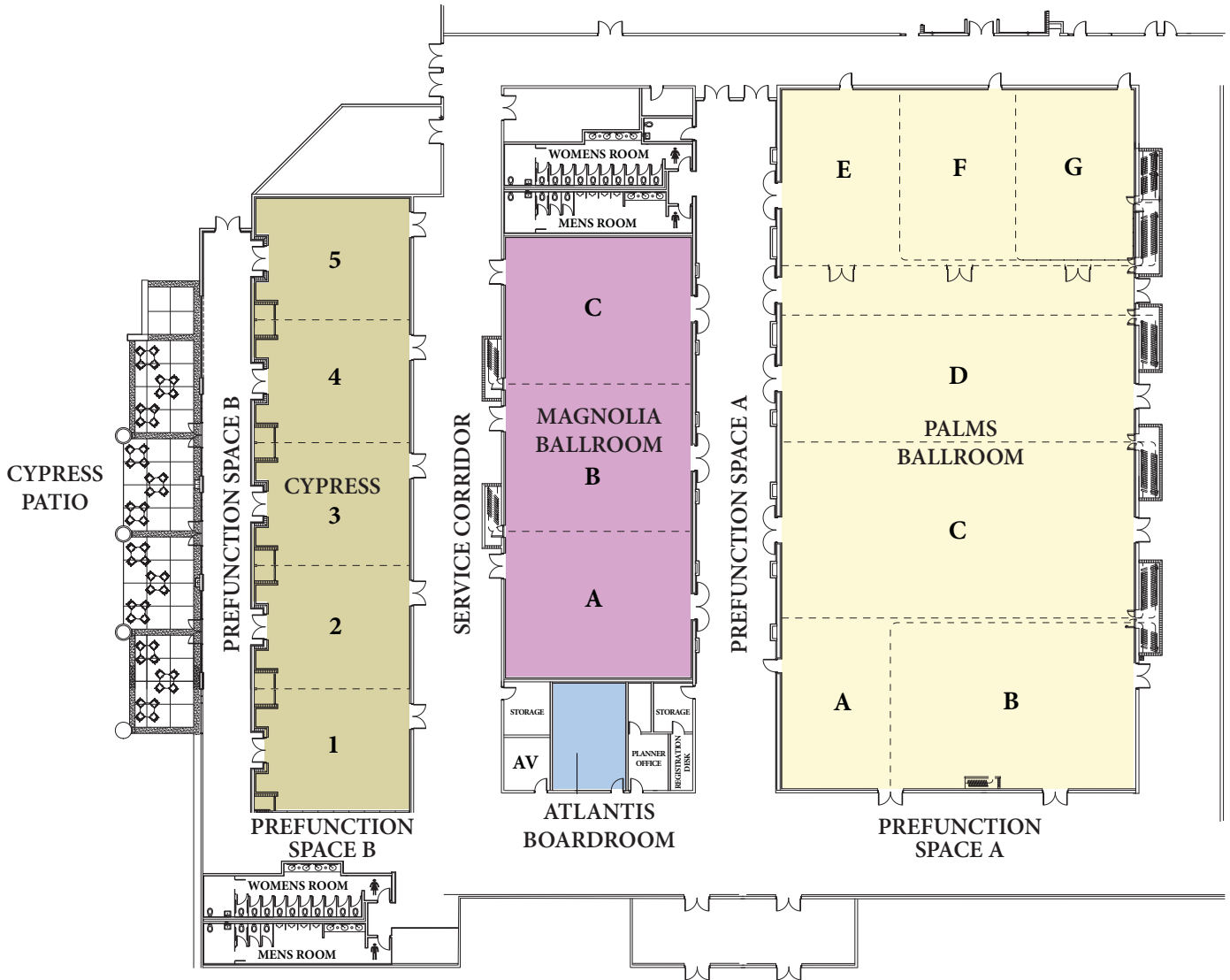

CAPACITY CHART

Room Name

Room Name	Dimensions	Area	Ceiling	Classroom 3 per 6'	Theatre	Light Reception	Banquets	Conference	U-Shape	Hollow Square	Exhibits 8 x 10
CONVENTION CENTER											
Palms Ballroom	172' 86'6"	14,768	24'	896	1,400	1,300	1,050	150	168	192	92
Palms Ballroom – A	42'8" 28'5"	1,239	24'	72	96	105	60	34	36	42	7
Palms Ballroom – B	42'8" 58'3"	2,517	24'	144	200	180	150	44	54	64	13
Palms Ballroom – C	43'5" 86'6"	3,771	24'	252	360	300	210	72	78	92	20
Palms Ballroom – D	30'9" 86'6"	2,675	24'	168	272	250	140	72	78	76	14
Palms Ballroom – E	43' 28'6"	1,238	24'	72	96	100	60	30	36	42	8
Palms Ballroom – F	43' 29'2"	1,021	24'	72	96	100	60	30	36	42	9
Palms Ballroom – G	43' 28'7"	1,232	24'	72	96	100	60	30	36	42	9
Palms Ballroom – ABCD	117' 86'6"	10,202	24'	624	900	900	700	102	105	160	63
Palms Ballroom – ABC	86'3" 86'6"	7,527	24'	462	684	550	490	72	99	130	49
Palms Ballroom – AB	42'8" 86'6"	3,756	24'	252	340	300	210	72	78	88	21
Palms Ballroom – CD	74' 86'6"	6,446	24'	420	576	525	420	72	93	118	42
Palms Ballroom – CDEFG	129' 86'6"	11,012	24'	660	1,044	1,000	770	96	129	168	67
Palms Ballroom – DEFG	85'10" 86'6"	7,241	24'	420	684	600	490	72	99	136	39
Palms Ballroom – EFG	43' 86'6"	3,491	24'	216	320	400	210	72	78	88	25
Palms Corridor	12'2" 86'6"	1,075	24'	n/a	n/a	n/a	n/a	n/a	n/a	n/a	n/a
Magnolia Ballroom	107'3" 45'	4,946	18'-6"	306	520	450	270	108	99	114	24
Magnolia Ballroom – A	35'9" 45'	1,643	18'-6"	105	144	180	90	34	42	54	7
Magnolia Ballroom – B	35'10" 45'	1,650	18'-6"	105	144	180	90	34	42	54	7
Magnolia Ballroom – C	35'10" 45'	1,653	18'-6"	105	144	180	90	34	42	54	7
Magnolia Ballroom – AB	71'8" 45'	3,293	18'-6"	210	288	350	180	60	66	90	15
Magnolia Ballroom – BC	71'9" 45'	3,303	18'-6"	210	288	350	180	60	66	90	15
Cypress	149'8" 35'	5,339	16'-5"	288	496	500	260	120	126	148	18
Cypress – 1	29'9" 35'	1,077	16'-5"	60	91	100	50	24	27	36	5
Cypress – 2	29'11" 35'	1,058	16'-5"	60	91	100	50	24	27	36	5
Cypress – 3	30' 35'	1,058	16'-5"	60	91	100	50	24	27	36	5
Cypress – 4	30' 35'	1,059	16'-5"	60	91	100	50	24	27	36	5
Cypress – 5	30'1" 35'	1,087	16'-5"	60	91	100	50	24	27	36	5
Cypress – 1234	119'7" 35'	4,252	16'-5"	228	392	400	200	96	108	118	14
Cypress – 123	89'7" 35'	3,193	16'-5"	156	280	300	150	72	78	88	12
Cypress – 12	59'7" 35'	2,135	16'-5"	96	192	200	100	48	54	62	8
Atlantis Boardroom	27'1" 17'10"	480	14'	n/a	n/a	n/a	n/a	12	n/a	n/a	n/a
Prefunction Space A	n/a n/a	5,019	20'	n/a	n/a	500	n/a	n/a	n/a	n/a	n/a
Prefunction Space B	n/a n/a	3,984	19'	n/a	n/a	500	n/a	n/a	n/a	n/a	n/a
Key West Terrace Indoor Foyer	40'6" 26'2"	1,047	9'-8"	n/a	n/a	131	n/a	n/a	n/a	n/a	n/a
OUTDOOR FUNCTION SPACE											
Porte Cochere	n/a n/a	n/a	19'-10"	n/a	n/a	n/a	n/a	n/a	n/a	n/a	n/a
Cypress Patio	18' 120'	2,315	10'-2"	n/a	n/a	110	90	n/a	n/a	n/a	n/a
Key West Terrace	59'3" 26'	1,346	10'	n/a	n/a	150	n/a	n/a	n/a	n/a	n/a
LEVEL 1											
Discovery Boardroom	15'10" 25'9"	428	10'	n/a	n/a	n/a	n/a	12	n/a	n/a	n/a
Endeavor Boardroom	12' 20'2"	240	10'	n/a	n/a	n/a	n/a	10	n/a	n/a	n/a

MORE REASONS TO MEET

- Free Made-To-Order Breakfast
- Complimentary Evening Reception*
- 300 Two-Room Suites
- 40,000 Total sq. ft. of Flexible Meeting, Prefunction and Event Space, including unique outdoor reception areas
- Lush Open Atrium
- Kyngs Grille Restaurant
- Oasis Lounge and The Marketplace
- Outdoor Swimming Pool, Exercise Room
- Business Center

*Service of alcohol subject to state and local laws. Must be of legal age.



TWO-ROOM SUITES



COMPLIMENTARY DRINKS



FREE MADE-TO-ORDER BREAKFAST



**EMBASSY
SUITES**

by HILTON™

Orlando Lake Buena Vista South

4955 Kyngs Heath Road
Kissimmee, FL 34746

407-597-4100
OrlandoLakeBuenaVistaSouth.EmbassySuites.com

ORLANDO
LAKE
BUENA
VISTA
SOUTH