

Magnolia

Meeting Space	Dimensions	Square Feet	Theater	Classroom	Banquet	Reception	Hollow Square	U-Shaped	8'x10' Exhibit
Ballroom	109' x 124'	13,500'	1,550	850	1,200	1,600	-	-	92
ABC	109' x 51'	5,550'	640	350	460	700	-	-	38
DEF	109' x 54'	5,550'	640	350	460	700	-	-	38
ABC & Corridor	109' x 73'	7,950'	910	500	660	1,000	-	-	45
DEF & Corridor	109' x 73'	7,950'	910	500	660	1,000	-	-	45
A	36' x 51'	1,850'	200	115	140	265	70	54	10
B	36' x 51'	1,850'	200	115	140	265	70	54	10
C	36' x 51'	1,850'	200	115	140	265	70	54	10
D	36' x 51'	1,850'	200	115	140	265	70	54	10
E	36' x 51'	1,850'	200	115	140	265	70	54	10
F	36' x 51'	1,850'	200	115	140	265	70	54	10
Corridor	109' x 22'	2,400'	-	-	-	-	-	-	-
Foyer	54' x 71'	3,800'	-	-	-	550	-	-	10

Azalea

Meeting Space	Dimensions	Square Feet	Theater	Classroom	Banquet	Reception	Hollow Square	U-Shaped	8'x10' Exhibit
Ballroom	109' x 51'	5,500	640	350	460	800	-	-	45
I	36' x 51'	1,850	200	115	140	265	70	54	10
II	36' x 51'	1,850	200	115	140	265	70	54	10
III	36' x 51'	1,850	200	115	140	265	70	54	10
Azalea Foyer	36' x 70'	2,500	-	-	-	370	-	-	6

Camellia

Meeting Space	Dimensions	Square Feet	Theater	Classroom	Banquet	Reception	Hollow Square	U-Shaped	8'x10' Exhibit
I & II	57' x 51'	2,900	330	180	220	400	-	-	21
I	28' x 51'	1,450	160	90	100	200	52	42	8
II	28' x 51'	1,450	160	90	100	200	52	42	8

Jasmine

Meeting Space	Dimensions	Square Feet	Theater	Classroom	Banquet	Reception	Hollow Square	U-Shaped
Ballroom	26' x 29'	750	80	42	50	100	30	24

Oak Boardroom

Meeting Space	Dimensions	Square Feet	Theater	Classroom	Banquet	Reception	Hollow Square	U-Shaped
Boardroom	25' x 14'	350	Conference:	12	-	-	-	-

Cypress Boardroom

Meeting Space	Dimensions	Square Feet	Theater	Classroom	Banquet	Reception	Hollow Square	U-Shaped
Boardroom	25' x 14'	350	Conference:	12	-	-	-	-

Grand Lawn

Meeting Space	Dimensions	Square Feet	Theater	Classroom	Banquet	Reception	Hollow Square	U-Shaped
		10,000	-	-	-	-	-	-



THE BAYTOWNE CONFERENCE CENTER - MAIN LEVEL

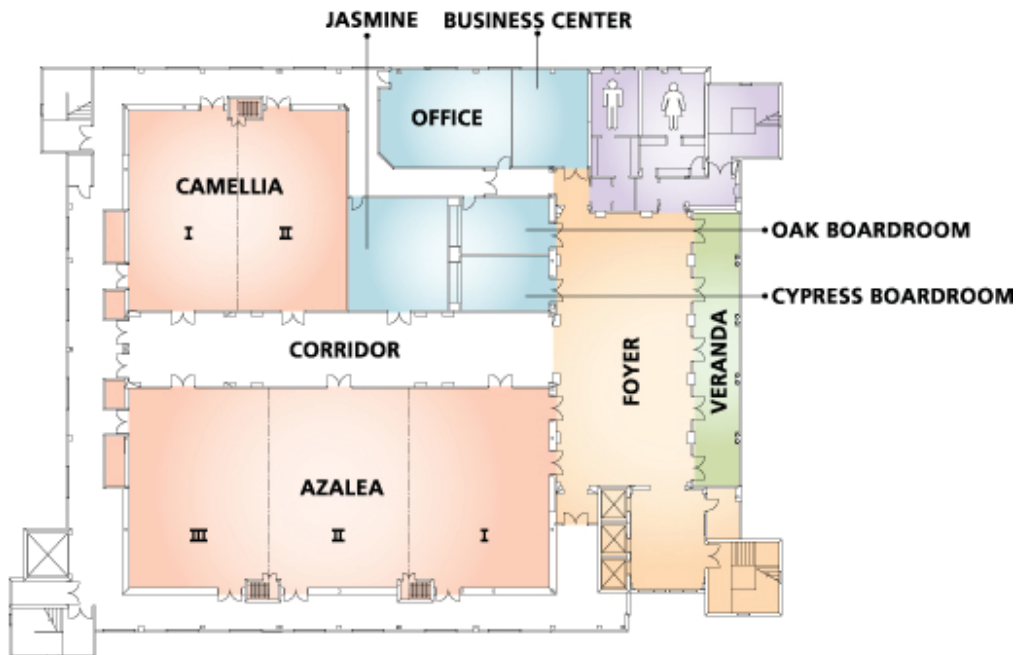

THE BAYTOWNE CONFERENCE CENTER - SECOND LEVEL